

SPECIFICATIONS:

Analog I/Os: (See Note 1)

- 0 - 5 V DC output, 8 - 30 V DC input, 35 mA max.
- 0.5 - 4.5 V DC output, 8 - 30 V DC input, 35 mA max.
- 0 - 10 V DC output, 12 - 30 V DC input, 35 mA max.
- 4 - 20 mA DC output, 18 - 30 V DC input, 60 mA max. (75 C max.)

Measuring Ranges: See range table

Zero and Full Scale: SenSet Adjustable

Linearity Error: ±0.15% of FSO (Full Span Output) typical, ±0.25% max.

Resolution: 0.025% of FSO

Update Rate: 300 Hz nominal

Operating Temperature Range: -20 to 85 C (-40 to 105 C extended temp.)

Temperature coefficient: ≤±0.015% of FSO/K

Humidity: 95% RH non-condensing

Vibration: 5-20 Hz, 0.5 inch p-p; 20-2000 Hz, 4.2 g p-p

Shock: 1000 g, 11 msec.

Pressure Media: Standard mineral oil and HWB hydraulic fluids

Pressure Rating: 5000 psig (350 bar) max. operating, 7500 psig (520 bar) proof

Note 1. Analog output is maximum at probe tip end; see technical data sheet to specify reversed output.

Specifications are subject to change without notice.

REVISIONS			
REV.	DESCRIPTION	DATE	APPROVED
A	Update Specifications to V2	02-02-15	EH
B	Update for Rev C Housing	03-28-16	EH
C	Edit dim ϕ .26 (was .27), reference ECN 16-177	09-20-16	EH
D	Update to 3-piece body. Ref: ECN 18-229	03-02-18	EH

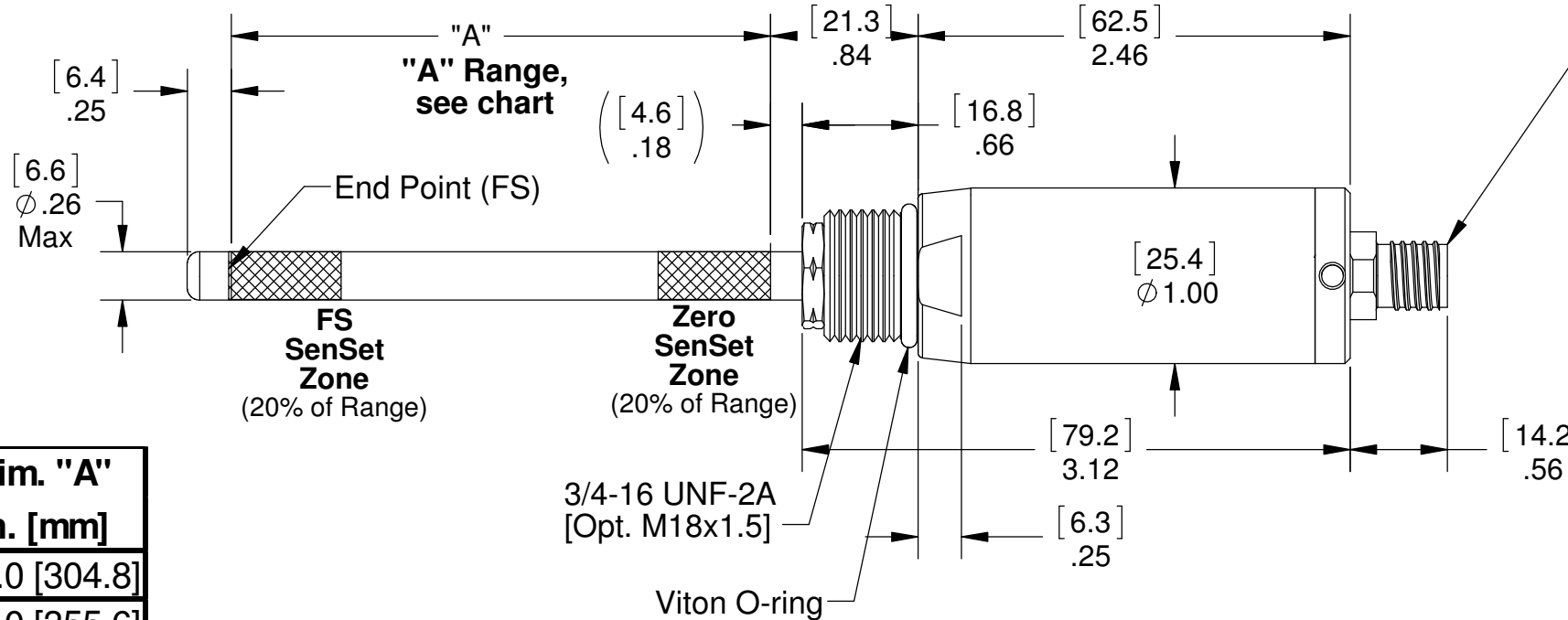
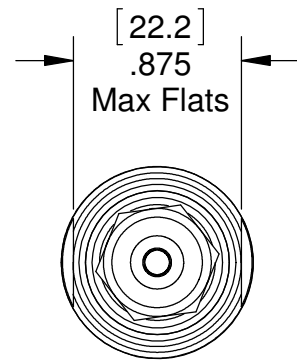

Impulse
IE55-1204-BCR
(Opt. SeaCon LSG-4-BC)

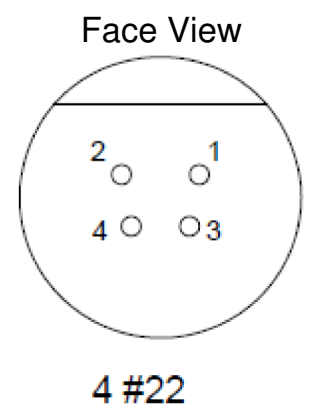

Nominal Range	Dim. "A" In. [mm]	Nominal Range	Dim. "A" In. [mm]
25 mm	1.0 [25.4]	300 mm	12.0 [304.8]
50 mm	2.0 [50.8]	350 mm	14.0 [355.6]
75 mm	3.0 [76.2]	400 mm	16.0 [406.4]
100 mm	4.0 [101.6]	450 mm	18.0 [457.2]
125 mm	5.0 [127.0]	500 mm	20.0 [508.0]
150 mm	6.0 [152.4]	600 mm	24.0 [609.6]
175 mm	7.0 [177.8]	700 mm	28.0 [711.2]
200 mm	8.0 [203.2]	750 mm	30.0 [762.0]
225 mm	9.0 [228.6]	800 mm	32.0 [812.8]
250 mm	10.0 [254.0]	900 mm	36.0 [914.4]

316 Stainless Steel Construction

4-Pin IE55-1204-BCR Conn.		UNLESS OTHERWISE SPECIFIED:		CONTRACT NO.		ALLIANCE SENSORS GROUP A DIVISION OF H.G. SCHAEVITZ LLC Moorestown, New Jersey USA alliancesensors.com	
I/O Function	Pin	1. DO NOT SCALE DRAWING 2. DIMENSIONS ARE IN INCHES 3. INTERPRET DIM/TOL PER ANSI Y14.5M-1994 4. DEBURR/BREAK SHARP EDGES 5. DIMS ARE BEFORE FINISH 6. (DATA) FOR REFERENCE ONLY		--			
+ Power Input	1	TOLERANCES		DRAWN BY: G E Miller	DATE: 10-30-14	SSX-7 Series Outline Outline SIZE: B CAGE CODE: N/A DWG. NO.: 3000-0017-XX REV: D FILENAME: 3000-0017, SSX-7 Assy SCALE: 1:1 RELEASE DATE: -- SHEET 1 OF 1	
Ground	2	DECIMAL: .XX ±.010 .XXX ±.005		ENGINEER: Ed Herceg	10-30-14		
Analog output	3	ANGULAR: ±.5°		CHECKED BY: Ed Herceg	10-30-14		
SenSet™	4	THIRD ANGLE PROJECTION		QA:	--		

DWG. NO. 3000-0017-XX REV. D EDITION 04-16-18 BY: GEM