

# SP1 Installation Guide

- includes:
- |        |          |
|--------|----------|
| SP1-4  | SP1-4-3  |
| SP1-12 | SP1-12-3 |
| SP1-25 | SP1-25-3 |
| SP1-50 | SP1-50-3 |

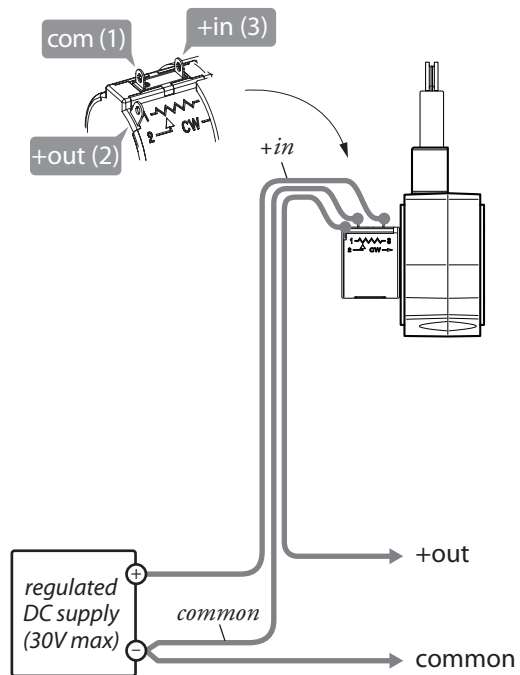

## Electrical Connection, SP1-xx



## Electrical Connection, SP1-xx-3

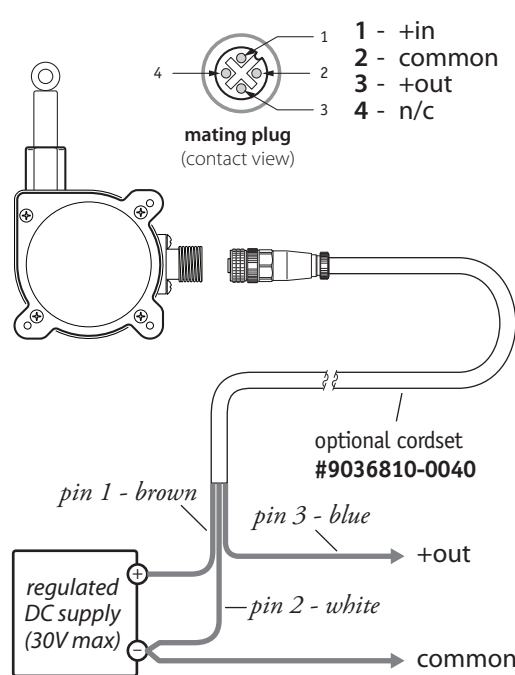

## Output Signal / Circuit

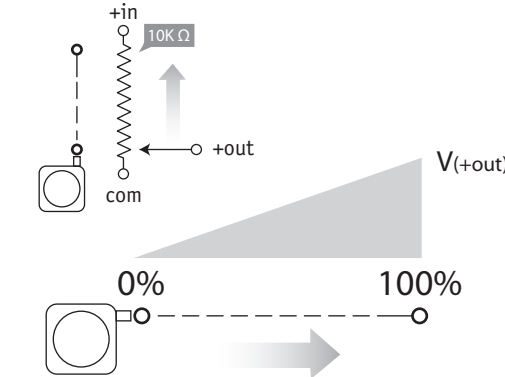

## Mating Plug (SP1-xx-3 only)

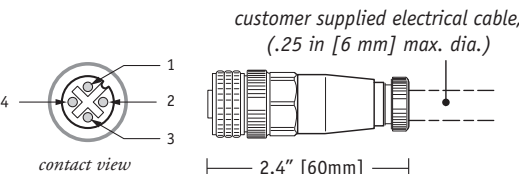

## Cable Exit/Connector Direction

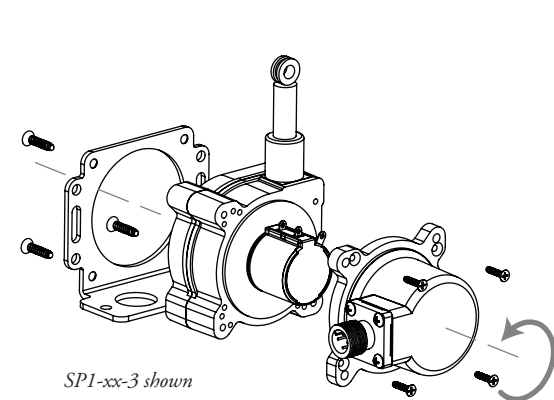

To change cable exit direction, simply remove the 3 mounting bracket screws and rotate sensor body to 1 of 4 options.

To change connector direction (SP1-xx-3 only), remove the 4 cover screws and carefully rotate to desired direction.

## alternate installation

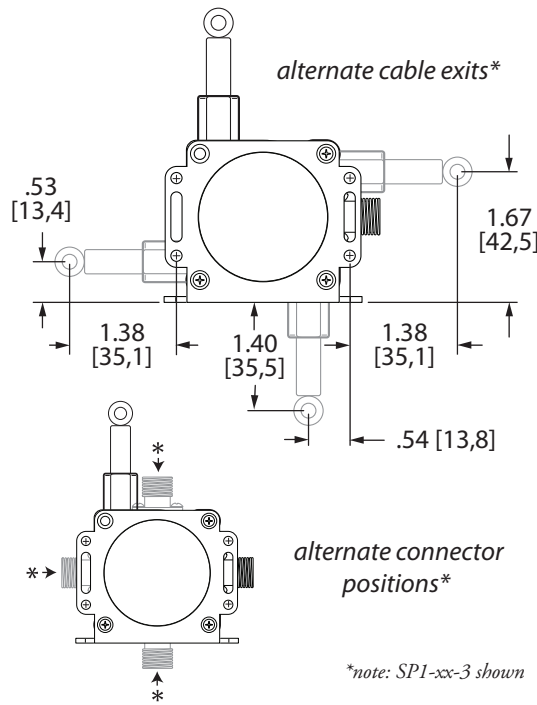

Front View, SP1-xx

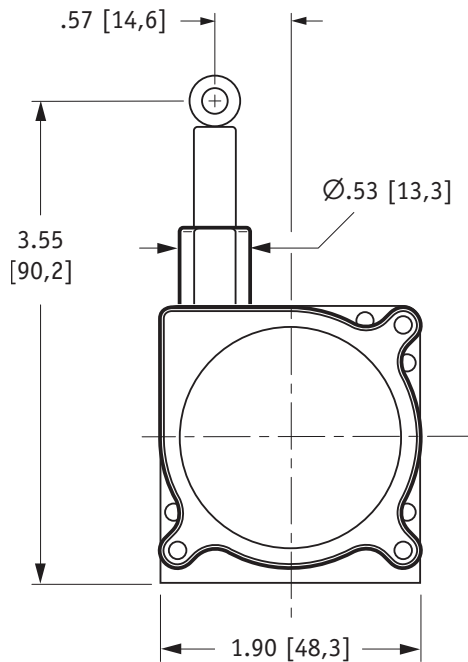

in [mm]

Front View, SP1-xx-3

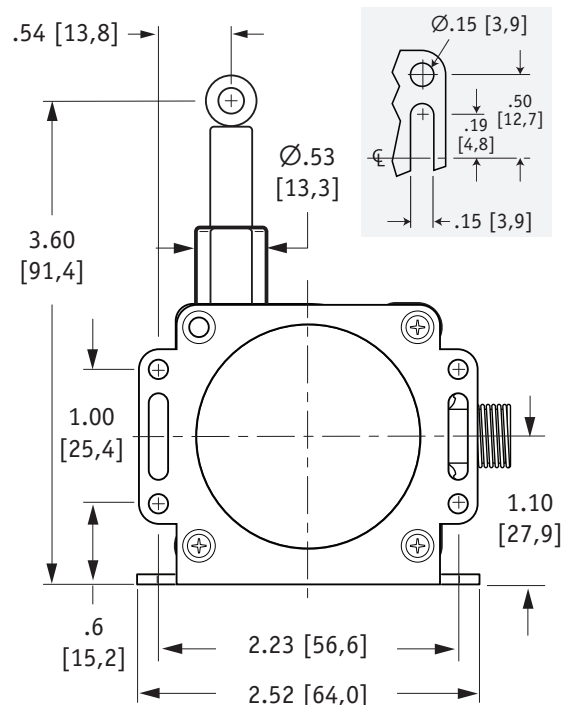

in [mm]

Side View, SP1-xx

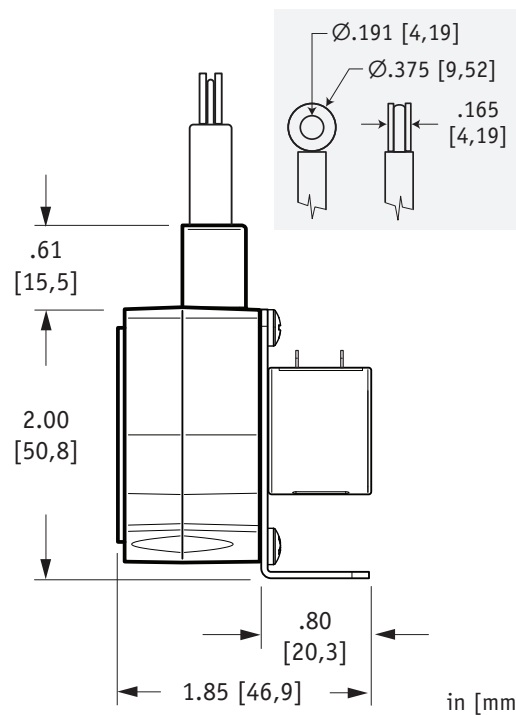

in [mm]

Side View, SP1-xx-3

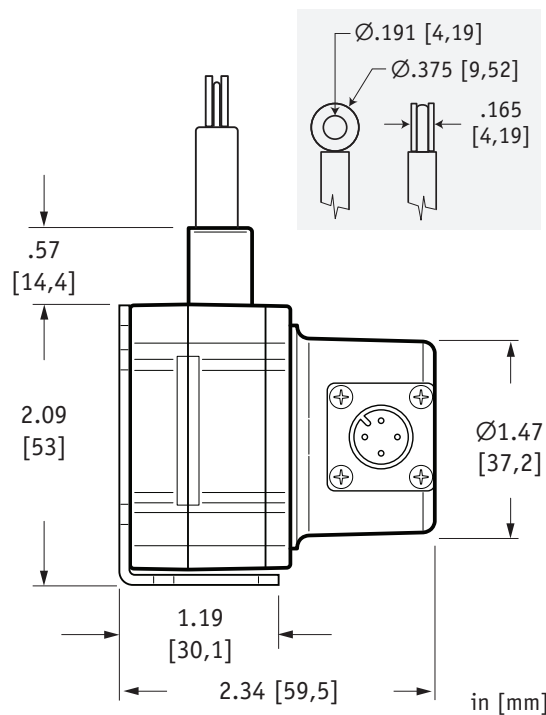

in [mm]

Top View, SP1-xx

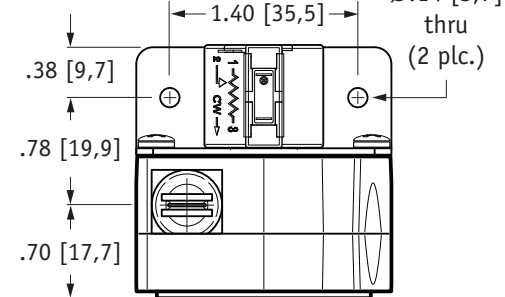

Top View, SP1-xx-3

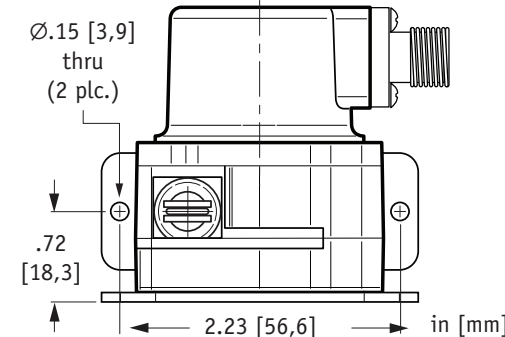

in [mm]

## Specifications

|                       |                              |
|-----------------------|------------------------------|
| Stroke Range Options: | 4.75, 12.5, 25 and 50 inches |
| Accuracy              |                              |
| 4.75-inch range:      | 1% fs.                       |
| all others:           | .25% fs.                     |
| Repeatability:        | ±.05% fs.                    |

|                          |                                      |
|--------------------------|--------------------------------------|
| Enclosure:               | polycarbonate                        |
| Measuring Cable:         | .019-in. dia. nylon-coated stainless |
| Measuring Cable Tension: | 7 oz.                                |
| Max Cable Acceleration:  | 15 g                                 |

|                                   |                              |
|-----------------------------------|------------------------------|
| Input Resistance:                 | 10K ohms, ±10%               |
| Sensor:                           | plastic hybrid potentiometer |
| Recommended maximum input voltage | 30V (AC/DC)                  |
| Power Rating:                     | 2 W at 70°F (21°C)           |
| Operating Temp:                   | 0°-160°F (-18° to 71°C)      |

Complete Specs: [celesco.com/\\_datasheets/sp1.pdf](http://celesco.com/_datasheets/sp1.pdf)