

# Model 3700 Accelerometer



Shock & Impact Testing  
Piezoresistive MEMS  
mV Output  
DC Response



The **Model 3700** is a MEMS piezoresistive shock accelerometer in a rugged stainless steel package. The accelerometer is available in ranges from is offered in ranges from  $\pm 50$  to  $\pm 6000g$  and is ideal for long duration shock transient measurements. The accelerometer incorporates mechanical over-range stops and is packaged in an industry standard footprint.

## FEATURES

- $\pm 50g$  to  $\pm 6000g$  Dynamic Range
- 20,000g Shock Protection
- Environmentally Sealed
- Gas Damping
- mV Output
- Stainless Steel Housing
- Bolt Mounted

## APPLICATIONS

- Impact Testing
- Structural Testing
- Transient Shock Testing
- Auto Safety Applications

## dimensions

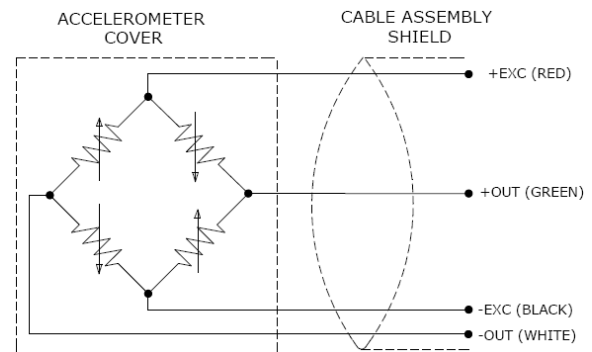
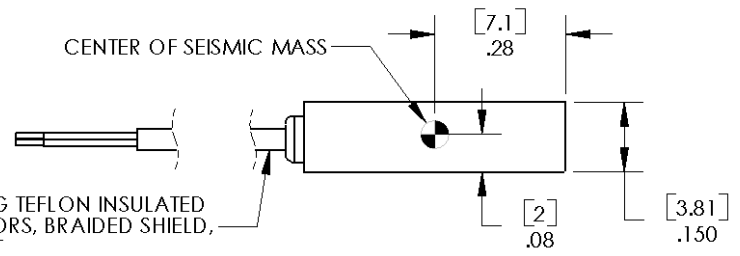
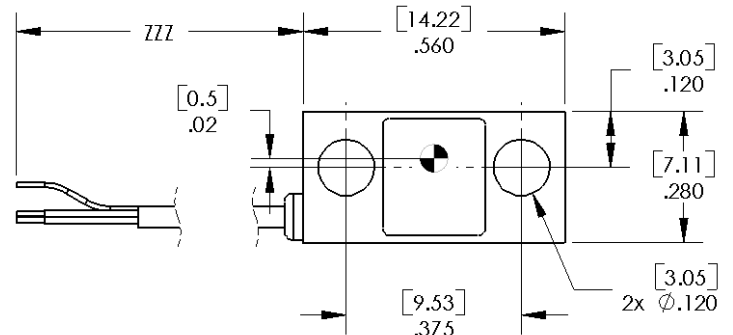

# Model 3700 Accelerometer

## performance specifications

All values are typical at +24°C, 100Hz and 10Vdc excitation unless otherwise stated. Measurement Specialties reserves the right to update and change these specifications without notice. Standard product parameters are described in PSC-1004 for Plug & Play DC Accelerometers.

Parameters							Notes
<b>DYNAMIC</b>							
Range (g)	±50	±100	±200	±500	±2000	±6000	
Sensitivity (mV/g) <sup>1</sup>	1.5	0.7	0.7	0.3	0.15	0.08	@10Vdc Excitation ±5%
Frequency Response (Hz)	0-800	0-1500	0-2000	0-4000	0-5000	0-6000	
Natural Frequency (Hz)	4000	6000	8000	15000	24000	26000	
Non-Linearity (%FSO)	±0.5	±0.5	±0.5	±1.0	±1.0	±2.0	
Transverse Sensitivity (%)	<3	<3	<3	<3	<3	<3	
Damping Ratio	0.7	0.7	0.6	0.5	0.4	0.3	
Shock Limit (g)	10000	10000	10000	10000	10000	10000	

<b>ELECTRICAL</b>							
Zero Acceleration Output (mV)	±25	±25	±25	±25	±25	±25	Differential
Excitation Voltage (Vdc)	2 to 10	2 to 10	2 to 10	2 to 10	2 to 10	2 to 10	
Input Resistance (Ω)	4000	4000	4000	4000	4000	4000	Typical
Output Resistance (Ω)	4000	4000	4000	4000	4000	4000	Typical
Insulation Resistance (MΩ)	>100	>100	>100	>100	>100	>100	@50Vdc
Residual Noise (µV RMS)	10	10	10	10	10	10	Maximum
Ground Isolation	Isolated from Mounting Surface						

<b>ENVIRONMENTAL</b>							
Thermal Zero Shift (%FSO/°C)	-0.09	-0.09	-0.09	-0.09	-0.09	-0.09	Typical
Thermal Sensitivity Shift (%/°C)	-0.15	-0.15	-0.15	-0.15	-0.15	-0.15	Typical
Operating Temperature (°C)	-55 to +125						
Compensated Temperature (°C)	Uncompensated						
Storage Temperature (°C)	-55 to +125						

<b>PHYSICAL</b>	
Case Material	Stainless Steel
Cable	Teflon Insulated Leads, Braided Shield, PFA Jacket
Weight (grams)	2.1
Mounting	2x #4-40 or M3 Mounting Screws
Mounting Torque	8 lb-in (0.9 N-m)
AWG	#36

<sup>1</sup> Output is ratiometric to excitation voltage

**Wiring color code:** +Excitation = Red; -Excitation = Black; +Output = Green; -Output = White;

**Supplied accessories:** 2x #4-40 Mounting Screws (1/4 inch length)

**Optional accessories:** AC-D03249      Triaxial Mounting Block  
101      Three Channel DC Signal Conditioner Amplifier

The information in this sheet has been carefully reviewed and is believed to be accurate; however, no responsibility is assumed for inaccuracies. Furthermore, this information does not convey to the purchaser of such devices any license under the patent rights to the manufacturer. Measurement Specialties, Inc. reserves the right to make changes without further notice to any product herein. Measurement Specialties, Inc. makes no warranty, representation or guarantee regarding the suitability of its product for any particular purpose, nor does Measurement Specialties, Inc. assume any liability arising out of the application or use of any product or circuit and specifically disclaims any and all liability, including without limitation consequential or incidental damages. Typical parameters can and do vary in different applications. All operating parameters must be validated for each customer application by customer's technical experts. Measurement Specialties, Inc. does not convey any license under its patent rights nor the rights of others.

## ordering info

PART NUMBERING    Model Number+Range+Cable Length

3700-XK-ZZZ

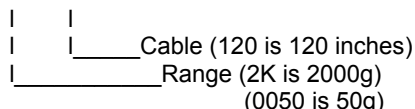
  
 Cable (120 is 120 inches)  
 Range (2K is 2000g)  
 (0050 is 50g)

Example: 3700-2K-120  
Model 3700, 2000g, 120" (10ft) Cable

### CONTATO

#### Endereço

Rua Sete de Setembro, 2671 - Centro  
13560-181 - São Carlos - SP - Brasil

#### Telefone

+ 55 (16) 3371-0112

#### Fax

+ 55 (16) 3372-7800

#### Internet

[www.metrolog.net](http://www.metrolog.net)  
[metrolog@metrolog.net](mailto:metrolog@metrolog.net)



Metrolog Controles de Medição